

DATA SHEET

Widra®



What is Widra®?

Widra® corner-beads are steel-wire products for inside and outside rendering. They are used to form straight corners when plastering.

Widra® is manufactured from heavily galvanized steel wire for excellent corrosion resistance.

Stainless steel Widra® corner beads should be applied for industrial, maritime environment and for the use of silicate, synthetic and silikon resin plasters.

Why use Widra®?

Widra® allows quick and accurate finishing at corners. For the fixing of Widra® are no fixing batons required. Widra® corner beads can be embedded in gypsum plaster, lime cement or cement-mortar. Special types are usable for modified plasters.

Widra® provides strong reinforcement for exposed corners. Widra® open steel wire construction allows render/mortar to fully key behind the beads to avoid cavities.

Where to use Widra®?

Internal plastering:

Gypsum plaster, lime-mortar, clay plaster:

Widra® IP

External rendering:

Lime-cement mortar, cement mortar:

Widra® AP-types with or without PVC-nose

Modified silicate, synthetic and silikon resin plasters: **Widra® APE/APP**

TECHNICAL DATA

	Length/ Element	Wires		Packaging		
		ø (mm)	Zinc min. (gr/m²)	Pcs/box	m/box	Box/palet
AP	2,95	1,40	200	40	118	40
APP	2,95	1,40	200 + polyester	40	118	40
APS	2,95	1,40	200	40	118	40
APE	2,95	1,40	-	40	118	20
APA	2,95	1,40	200	40	118	40
APR	2,95	1,40	200	40	118	20
APB	2,95	1,40	200	40	118	20
APK	2,95	1,40 + PVC-nose	200	25	73,75	30
APBK	2,95	1,40 + PVC-nose	200	25	73,75	30
APAK	2,95	1,40 + PVC-nose	200	25	73,75	30
APHK	2,95	1,40 + PVC-nose	200	20	59	20
IP	2,95	3,00	200	40	100	48
	2,50			40	118	48
IPE	2,95	2,00	-	40	18	24

PACKAGING



It's recommended to stack up the bundles horizontally.

STORAGE

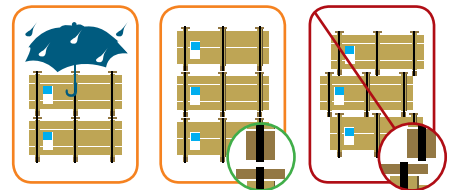

KEEP DRY

RIGHT

WRONG

QUALITY



ISO 9001



EUROPROFILES

Bekaert is close to the market. Bekaert seeks conformance to every necessary, national or international product quality standard. Widra is certified according to:

- ISO 9001
- EN 13658 - 1
- EN 13658 - 2
- CENITC 241

Please follow the application guidelines of Europrofiles, which can be downloaded at: www.europrofiles.com

For more information: www.bekaert.com/building
infobuilding@bekaert.com

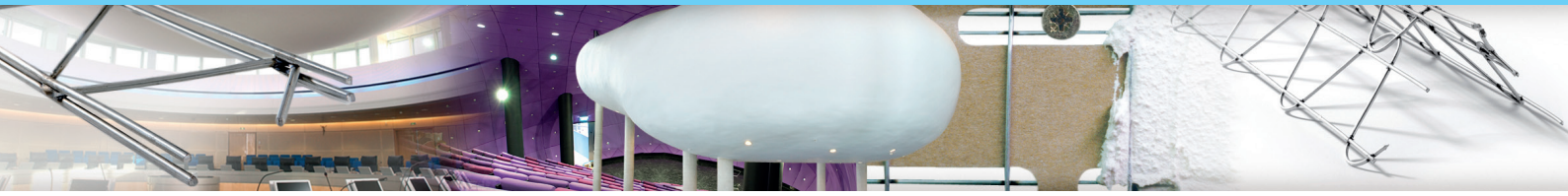

Different types of Widra®

PROFILES FOR RENDERING EXTERNAL WALLS

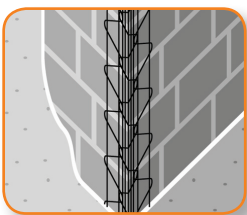

Widra® AP:

Corner bead for reinforcing external corners prior to rendering. Makes sure a perfect, quick and straight-line rendering.

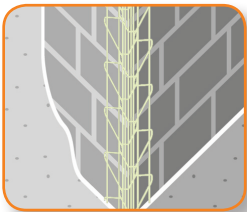

Widra® APP:

The galvanized and polyester coated corner bead for a better protection against corrosion.

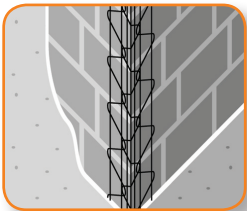

Widra® APS/APE:

Corner beads which ensure that even renders with coarser aggregates can fully "key" behind the bead wires. Stainless steel beads are available for harsh industrial, maritime environments and for the use of silicate, synthetic and silikon resin plasters.

Available: galvanized (APS)
stainless steel (APE)

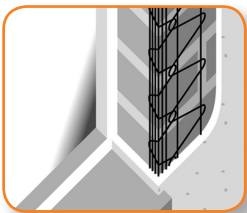

Widra® APA:

Corner beads for window and door openings in outside walls.

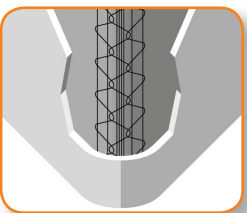

Widra® APR:

The corner bead to form perfectly finished round corners.

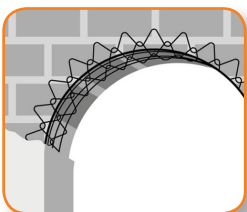

Widra® APB:

The corner bead which assures perfectly shaped arched constructions.

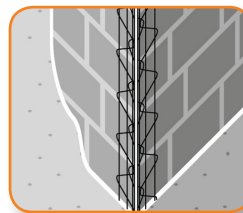

Widra® APK:

Corner beads for reinforcing external corners prior to rendering. To PVC nose provides improved visual appearance.

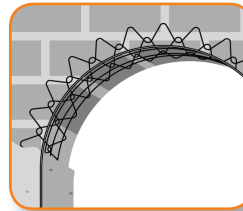

Widra® APBK:

Corner bead with PVC-nose to build with arched constructions.

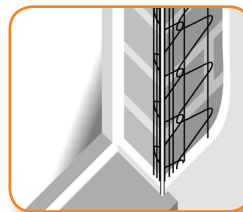

Widra® APAK:

Asymmetric corner bead with PVC-nose appropriate for outside wall applications around doors and windows.

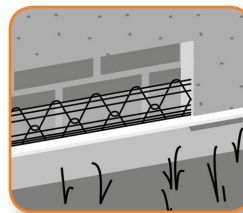

Widra® APHK:

Socle bead for rendering outside walls.

PROFILES FOR INTERNAL PLASTERING

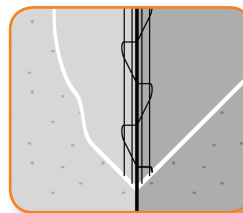

Widra® IP/IPE:

Corner beads for reinforcing internal corners prior to plastering. The beads have a high integral strength but are sufficiently flexible to be formed to meet most normal design profiles.

Available: Galvanized (IP)
Stainless steel (IPE)

Bekaert will advise on the most suitable Widra® type for your application. Ask for our recommendations on type, amount and placing at:

www.bekaert.com/building
infobuilding@bekaert.com